

PRODUKTBESCHREIBUNG

- » Passend zu HWS 100 und HWS 102
- » Befestigung mittels HWS 1002 oder HWS 1004

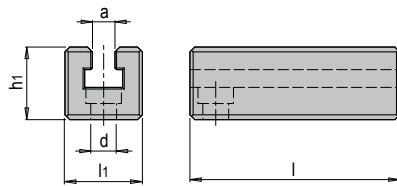

l	h1	l1	a	d	SK ¹⁾	Nr.	EUR
104	38	38	14	M10, M12	16	HWS 1006/16	<>
130	45	47	14	M12, M16	20	HWS 1006/20	<>
140	48	55	18	M16, M18, M20	25	HWS 1006/25	<>
178	59	74	28	M20, M24	55	HWS 1006/55	<>

1) SK: max. Spannkraft [kN]