

PRODUCT DESCRIPTION

- » With integrated length adjustment screw
- » High clamping forces
- » Optimal workpiece surfaces and longer service lives thanks to very good damping properties
- » Best concentricity
- » With Balluf chip hole

APPLICATION

- » For clamping of tools with cylinder shank in the h6 shank tolerance
- » Use in combination with reduction sleeve enables flexible clamping
- » For drilling, reaming and milling

INCLUDED IN THE DELIVERY

- » Includes built-in length adjustment screw, user guide and hexagon

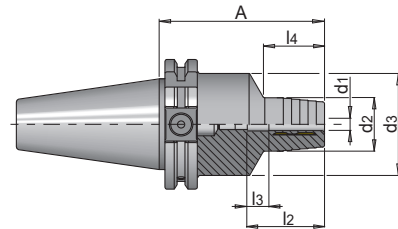

d2	d3	l2	l3	l4	Interface	d1	A	No.	EUR
26	49.5	37	10	29.5	SK 40	6	80.5	HWZ 2261/SK40/ 6/ 80,5	< >
28	49.5	37	10	30	SK 40	8	80.5	HWZ 2261/SK40/ 8/ 80,5	< >
30	49.5	41	10	35	SK 40	10	80.5	HWZ 2261/SK40/10/ 80,5	< >
32	49.5	46	10	40	SK 40	12	80.5	HWZ 2261/SK40/12/ 80,5	< >
38	49.5	49	10	45	SK 40	16	80.5	HWZ 2261/SK40/16/ 80,5	< >
42	49.5	51	10	47	SK 40	20	80.5	HWZ 2261/SK40/20/ 80,5	< >